

Index

ABOUT CENTURION	01
FEATURES	01
SPECIFICATIONS	01
DIAGRAM	02
INSTALLATION	04
REMOVING THE SIDE PANELS	04
INSTALLING THE MOTHERBOARD	04
TO INSTALL/ REPLACE THE POWER SUPPLY UNIT (PSU):	04
INSTALLING DRIVES (CD-ROM, HDD, FDD, ETC.)	05
REPLACING/INSTALLING THE CASE FANS	06
1. Replacing / Installing the Rear Case Fan	06
2. Replacing / Installing the Front Case Fans	06
I/O FUNCTION PANEL INSTALLATION GUIDE	06

About Centurion

"Centurion" represents quality of Discipline, Honor, Integrity & Loyalty.
Now you don't have to be a Caesar to concord the digital world while feeling safe and proud..

Features

- Discipline Asymmetrical shape layout.
- Royal Appearance Equipped with detailed high gloss front Alloy Shield.
- Protection Proactive heat resistant design for abusive ambient environment
- Integrity World famous solid assembly.
- Unique Armor Unique side panel mechanism provides great accessibility for installation & upgrade.
- Loyalty - Long lasting ownership.
- Tool-free assembly/disassembly for quick and maintenance or upgrade
- Special perforated screen design provides the superior airflow and maximum cooling performance; easy to clean and maintain

Specifications

- Dimensions: 480 mm x 202 mm x 435 mm (L x W x H)
- Material: Aluminum Bezel, SECC Chassis
- Main Board: ATX; 12"x 9.6" (30.5cm x 24.5cm)
- 5.25" Drive Bay: 5 (Exposed)
- 3.5" Drive Bay: 1 (Exposed), 4 (Hidden)
- Power Supply: Standard ATX PS2
- Front I/O: USB 2.0 x 2, IEEE 1394 (FireWire) x1, MIC x1, SPK x 1
- Cooling fan: One 80 x 80 x 25 mm Front Fan (intake)
One 120 x 120 x 25 mm Rear Fan (exhaust)

Diagram

A. 3 Direction Diagram

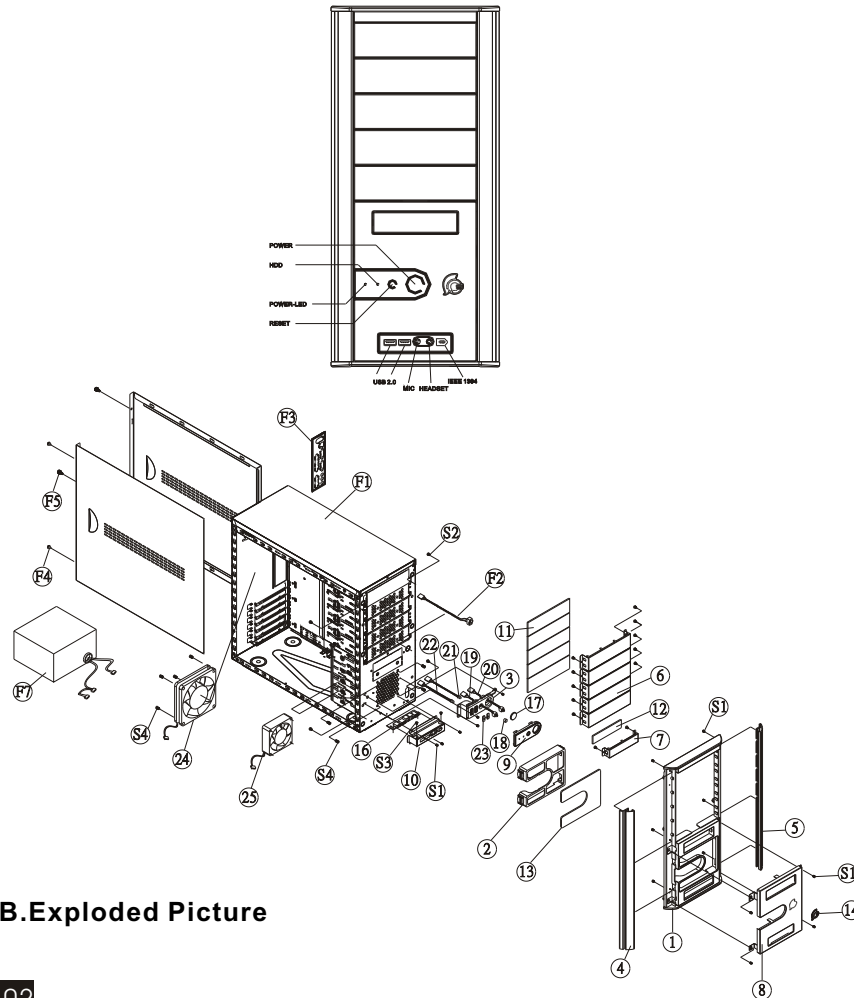

B. Exploded Picture

no.	English	繁體中文	簡體中文	German	French	Italian	Spanish	Portuguese	Japanese
1	Bezel	塑膠面框	塑膠面框	Plastikeinfassung	Biseau plastique	Comico sfaccettata di plastica	Panel plástico	Panel plástico	プラスチックベゼル
2	Filter Holder	濾網框	濾網框	Filterhalter	Montant du filtre	Supporto Filtro	Soporte del filtro	Soporte do filtro	フィルタホルダー
3	Button Assy Holder	按鈕架	固定架	Fixierter Halter	Montant fixe	Supporto Fisso	Soporte fijo	Soporte fijo	固定ボタン架
4	Left bar	左側鎖柱	左側鎖柱	Linke Leiste	Barre gauche	Barra izquierda	Barra izquierda	Barra esquerda	左バー
5	Right bar	右側鎖柱	右側鎖柱	Rechte Leiste	Barre droite	Barra destra	Barra derecha	Barra direita	右バー
6	5.25" Mesh Cover	5.25" 沖孔網板	5.25" 沖孔網板	5.25" Maschenabdeckung	Maille Couvercle 5.25"	Coperchio 5.25" a Rete	Tapa de la malla de 5.25 pulgadas	Tampa de malha de 5.25 polegadas	5.25" メッシュカバー
7	3.5" Mesh Cover	3.5" 沖孔網板	3.5" 沖孔網板	3.5" Maschenabdeckung	Maille Couvercle 3.25"	Coperchio 3.5" a Rete	Tapa de la malla de 3.5 pulgadas	Tampa de malha de 3.5 polegadas	3.5" メッシュカバー
8	Lower Mesh Bezel	沖孔網下面板	沖孔網下面板	Untere Maschenabdeckung	Biseau e Maille inférieure	Comico sfaccettata inferiore a Rete	Panel de la malla inferior	Panel de malha inferior	下メッシュベゼル
9	Button Assy Plate	按鈕架板	按鈕架板	Tastenplatte	Plaqueau des boutons	Piastra Pulsanti	Placa de botones	Placa de botões	ボタンプレート
10	Front IO Plate	前面IO板	前面IO板	Vordere I/O-Platte	Plateau Avant E/S	Piastra I/O Frontale	Placa de E/S frontal	Placa de E/S frontal	前面I/Oプレート
11	5.25" Filter	5.25" 濾網	5.25" 濾網	5.25" Filter	Filtre 5.25"	Filtro 5.25"	Filtro de 5.25 pulgadas	Filtro de 5,25 polegadas	5.25" フィルタ
12	3.5" Filter	3.5" 濾網	3.5" 濾網	3.5" Filter	Filtre 3.25"	Filtro 3.5"	Filtro de 3.5 pulgadas	Filtro de 3,5 polegadas	3.5" フィルタ
13	Lower Filter	下面濾網	下面濾網	Untere Filter	Filtre inférieur	Filtro inferiore	Filtro inferior	Filtro inferior	下フィルタ
14	Name Plate	銘牌	銘牌	Namensplatte	Plaque de nom	Targhetta del nome	Placa de identificación	Placa de identificação	名前板
15	Control Board	USB 模組	USB 模組	USB-Modul	Module USB	Modulo USB	Modulo USB	Modulo USB	USB モジュール
16	Power button	電源開關	電源開關	Einf/Aus-Taste	Bouton Alimentation	Pulsante della corrente	Botón de encendido	Botão liga / desliga	電源ボタン
17	Reset button	重設按鈕	重設按鈕	Zurücksetzen-Taste	Bouton Reinitialiser	Pulsante Reset	Botón Restablecer	Botão Redefinir	リセットボタン
18	Reset Cable	重設線	重設線	Zurücksetzen-Kabel	Cable Reinitialisation	Cavo di Reimpostazione	Cable de Reestablecer	Cabo de Redefinir	リセットケーブル
19	Power Cable	電源線	電源線	Netz-kabel	Cable alimentation	Cavo di Corrente	Cable de alimentación	Cabo de alimentação	電源ケーブル
20	HDD LED Cable	HDD LED 燈線	HDD LED 燈線	HDD LED-Kabel	Cable LED disque dur	Cavo LED HDD	Cable del LED de la unidad de disco duro	Cabo do LED da unidade de disco rígido	HDD LED ケーブル
21	Power LED Cable	電源 LED 燈線	電源 LED 燈線	Strom-LED-Kabel	Cable LED Alimentation	Cavo LED Corrente	Cable del LED de encendido	Cabo do LED de energia	電源 LED ケーブル
22	LED Mask	LED 遮光板	LED 遮光板	LED-Maske	Masque LED	Maschera LED	Máscara del LED	Máscara do LED	LED マスク
23	Fan 120x 25 mm	120mm 風扇	120mm 風扇	120x 25 mm-Ventilator	Ventilateur 120x 25 mm	Ventilatore 120x 25 mm	Ventilador 120x 25 mm	Ventilador 120x 25 mm	120x 25mm ファン
24	Fan 80x 25 mm	80mm 風扇	80mm 風扇	80x 25 mm-Ventilator	Ventilateur 80x 25 mm	Ventilatore 80x 25 mm	Ventilador 80x 25 mm	Ventilador 80x 25 mm	80x 25mm ファン
25	Fan 80x 25 mm	80mm 風扇	80mm 風扇	80x 25 mm-Ventilator	Ventilateur 80x 25 mm	Ventilatore 80x 25 mm	Ventilador 80x 25 mm	Ventilador 80x 25 mm	80x 25mm ファン
S1	#6-32 Screw	#6-32 螺絲	#6-32 螺絲	#6-32-Schraube	Vis #6-32	Vite #6-32	Tornillo #6-32	Parafuso #6-32	#6-32 ねじ
S2	M3* L6 Screw	M3* L6 螺絲	M3* L6 螺絲	M3* L6-Schraube	Vis M3* L6	Vite M3* L6	Tornillo M3* L6	Parafuso M3* L6	M3* L6 ねじ
S3	M3* L4 Screw	M3* L4 螺絲	M3* L4 螺絲	M3* L4-Schraube	Vis M3* L4	Vite M3* L4	Tornillo M3* L4	Parafuso M3* L4	M3* L4 ねじ
S4	#5* L10 Screw	#5* L10 螺絲	#5* L10 螺絲	#5* L10-Schraube	Vis #5* L10	Vite #5* L10	Tornillo #5* L10	Parafuso #5* L10	#5* L10 ねじ
F1	Chassis	機殼	機殼	Gehäuse	Chassis	Telaio	Chasis	Chassi	シャーシ
F2	Buzzer	蜂鳴器	蜂鳴器	Summeer	Sonnerie	Ciccinio	Zumbador	Alarma sonora	ブザー
F3	I/O Plate	I/O 板	I/O 板	I/O-Platte	Plateau E/S	Piastra I/O	Placa de E/S	Placa de E/S	I/O プレート
F4	#6-32 Screw	#6-32 螺絲	#6-32 螺絲	#6-32-Schraube	Vis #6-32	Vite #6-32	Tornillo #6-32	Parafuso #6-32	#6-32 ねじ
F5	Thumb Screw	手鎖螺絲	手鎖螺絲	Schraube	Vis punaise	Vite a testa piatta	Tornillo	Parafuso	棒ねじ
F6	PSU	電源供應器	電源供應器	PSU	Unité d'alimentation	PSU	Fuente de alimentación	Fonte de alimentação	電源

Installation

■ Removing the Side Panels

Step: Unscrew the side panel and remove it.

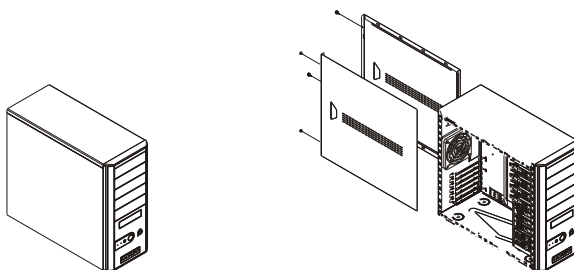

■ Installing the Motherboard

Step:

1. Unscrew the side panel and remove it.
2. Lay the chassis
3. Locate the motherboard with the location of motherboard screw location.
4. Secure the motherboard with suitable screws.

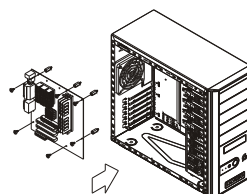

■ To install/ replace the Power Supply Unit (PSU):

Step:

1. Locate the PSU at chassis PSU rack.
2. Secure PSU with available screws.
3. You finished installing the PSU.

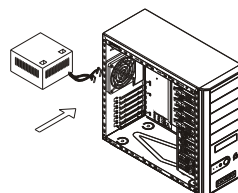

■ Installing Drives (CD-ROM, HDD, FDD, etc.)

Step:

1. Remove the side panel and chassis front plate.
2. Choose a 5.25 drive bay, unscrew the drive bay plate.
3. Secure the chassis front plate.
4. Place your device into it.

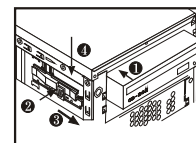
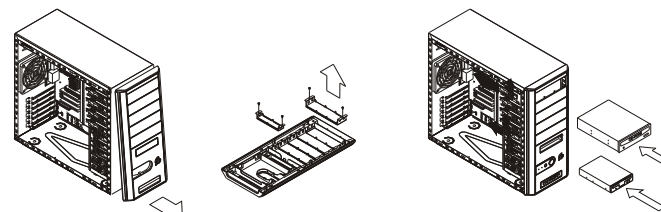

- ① Slide CD-ROM, HDD, FDD into the 5.25 and 3.5 bay
- ② Fit the holder's hole completely
- ③ Push plastic rail to the front part
- ④ Press plastic lock down to lock

Replacing/Installing The Case Fans

■ 1. Replacing / Installing the Rear Case Fan

Step:

- 1.Remove the side panel
- 2.Remove four screws securing the exterior fan cover.
- 3.Place the rear fan in position and secure it with four screws.

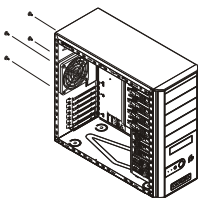

■ 2. Replacing / Installing the Front Case Fans

Step:

- 1.Remove the side panel
- 2.Remove the front panel
- 3.Remove four screws securing the exterior fan cover
- 4.Place the rear fan in position and secure it with four screws

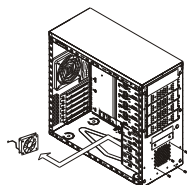

I/O function panel installation guide

Please refer to the illustration on the section of USB,1394,Audio connector from motherboard user's manual , and please select the motherboard which use the same USB,1394,Audio standard as below . Otherwise , it will cause damage for user's device.

- The following illustration is a connection diagram for the Front Pane I/O cable.
- Doing so will damage the device. NEVER connect a 1394 cable to the USB connector.
- NEVER connect a USB cable to the 1394 connector. Doing so will damage the device.
- On some motherboards the connectors for 1394, USB and audio are not the same as the below drawing. Please check with your motherboard manual before install.

Mother Board

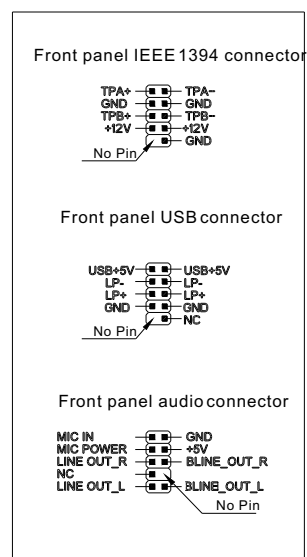

Cable

IEEE 1394 Connector

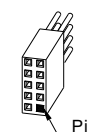

USB Connector

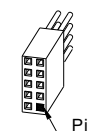

Front panel audio connector (BLACK)

